

# THE STRONG POINTS OF FLATFIX FUSION

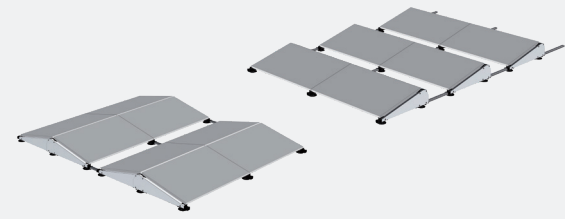

## 🕒 SINGLE OR DUAL SETUP

- South
- East-West
- North-South

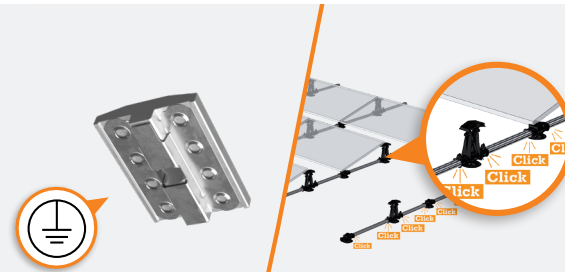

## 🕒 MOUNTING TIME

- Modular construction with minimal number of components
- One-tool approach
- Fixed dimensions
- Integrated synchronization of panels

## 🚚 TRANSPORT AND HANDLING

- Minimal number of components
- Lightweight materials
- Connectable short profiles for easy transport
- Fixed dimensions

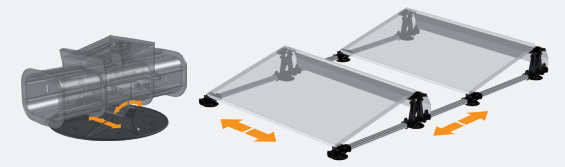

## 🌡️ THERMAL DECOUPLING SYSTEM

- Lightweight, optimal ballast
- Different types of ballast possible
- Self-leveling base plates
- Extra base plates to be added flexibly
- Low point load
- Applicable to any type of roofing material

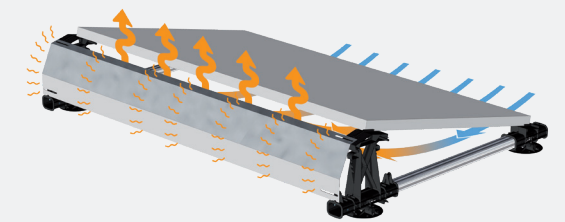

## 🌪️ AERODYNAMIC CLOSED SYSTEM

- Storm-proof
- Minimal forces on the solar panel: longer lifespan
- Passively cooled, resulting in high yield
- Aesthetic

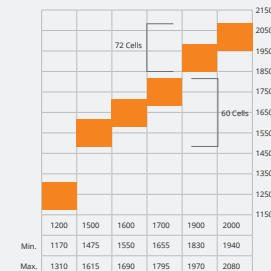

## 📏 ALSO FOR LARGER PANELS

- Panel width standard up to 1016mm
- Panel width with extension up to 1050mm
- Panel length up to 2080mm



# THE INNOVATIVE AND SUPER-FAST SYSTEM FOR FLAT ROOFS

**FLATFIX FUSION**

**QUICK  
RELIABLE  
INNOVATIVE**

## MAKE THE CLICK WITH ESDEC

Esdec has been developing, producing, and supplying professional roof-mounting systems for solar panels since 2004. ClickFit and FlatFix are inspired by all installers who regularly install solar panels. Easy, fast, reliable installation using innovative, high-quality, durable mounting systems: Esdec makes it possible.

**Esdec**  
Londenstraat 16  
7418 EE Deventer  
The Netherlands

☎ +31 850 702 000  
✉ info@esdec.com

30042019





## UP TO 40% FASTER INSTALLATION

FlatFix Fusion is a revolutionary and lightweight racking system for solar panels on both large and small surface flat roofs. The system can be mounted in different ways so as to come to the ideal solution. Flatfix Fusion was designed for quick and easy mounting of solar panels on a flat roof, while minimising the number of components needed. The main components are being assembled by means of a simple click system. The mounting of the actual solar panels requires only a single tool.

### Thermal action

The various components are connected using fast-click connectors. The connected roof supports ensure the system has room to thermally expand without damaging the roofing material. And that means the base plates of the building space is not transferred to the PV system or vice versa. This prevents damage to the PV system and the roofing material. Plastic for instance is one of the best materials in combination with PVC plasticizer exudation.

### Warranty

The patented FlatFix Fusion system is continually tested in a wind tunnel and as per other prevailing norms. FlatFix Fusion is a 100% Dutch product with a unique standard warranty of 20 years.



Quick and easy installation



Lightweight



Minimal SKU's



One-tool approach



Standard 20-year warranty

### Dual setup

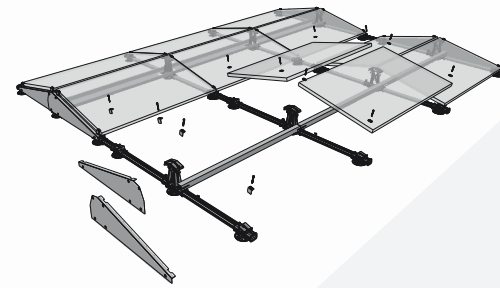

1

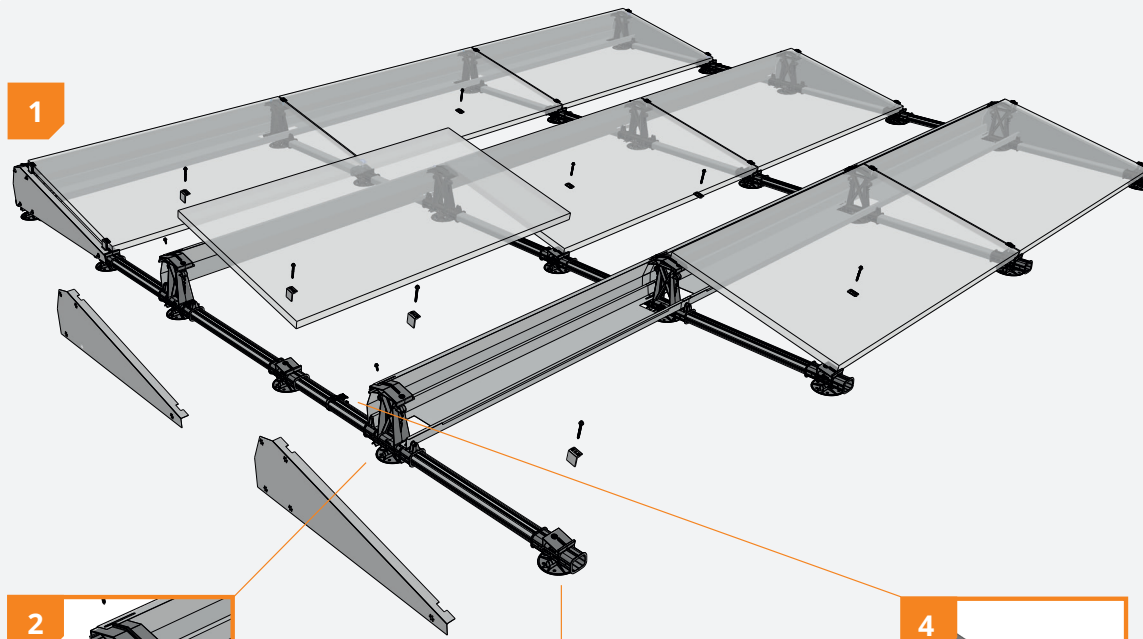

2

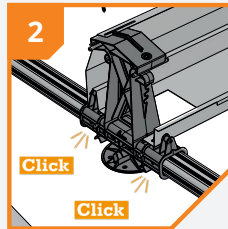

3

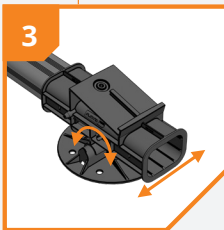

4

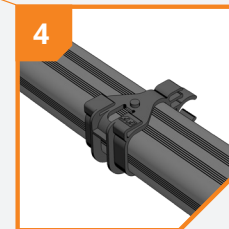

#### 1 Lightweight system

Due to its connected and closed structure, the system only has to be provided with ballast at a few optimal points.

#### 2 Unique click connector

The revolutionary and unique click connectors make the FlatFix Fusion system a very fast and easy to install mounting system. All further mounting requires only a single tool.

#### 3 Unique thermal decoupling

Using self-adjusting base plates, the FlatFix Fusion system is thermally decoupled. These connected base plates ensure the system has room to thermally expand without damaging the roofing material.

#### 4 Integrated cable management

The cables and plugs of the solar panels can be safely and easily secured to the mounting system. This reduces installation times and increases the quality of the system.

## SYSTEM COMPONENTS

	<b>FlatFix Fusion Base Plate</b> 1007010
	<b>FlatFix Fusion Low Base</b> 1007021 1007021-S (with synchronization)
	<b>FlatFix Fusion High Base</b> 1007030 1007030-S (with synchronization)
	<b>FlatFix Fusion Cable-clip Optimizer Ready</b> 1007041
	<b>FlatFix Fusion Wind Deflector Rear 1600*/**</b> 1007050

	<b>FlatFix Fusion Wind Deflector, left**</b> 1007055
	<b>FlatFix Fusion Wind Deflector, right**</b> 1007056
	<b>FlatFix Fusion Ballast Holder*</b> 1007060
	<b>FlatFix Fusion Stabilizer*</b> 1007070
	<b>FlatFix Fusion Base profile**</b>
	210mm 1007121
	370mm 1007137
	550mm 1007155
	750mm 1007175
	940mm 1007194

\* Also available in 1200, 1500, 1600, 1700, 1900 & 2000  
\*\* Also available in black

## FASTENERS

	<b>Esdec Mounting Screw*</b>	
	6,5x19mm	1006519
	6,5x55mm	1006555
	6,5x60mm	1006560
	6,5x63mm	1006563
	6,5x70mm	1006570
	6,5x75mm	1006575
	<b>Esdec Screw</b>	
	6,0x25mm (self tapping)	1003010
	6,5x19mm (self drilling)	1003015

\* Depending on panel thickness and related terminal clamp

## CLAMPS

	<b>Universal Module Clamp with synchronization**</b> 1003022
	<b>FlatFix End Clamp 31-50mm*/**</b> 10041_

\* Depending on panel thickness (in mm)  
\*\* Also available in black

## ACCESSORIES

	<b>FlatFix Fusion Grounding Ring</b> 1007501		<b>Roof support adapter</b> 1007011
	<b>FlatFix Fusion Grounding Spring</b> 1007502**		<b>Low base extension</b> 1007021-WP
	<b>FlatFix Fusion Grounding Clamp</b> 1007505		<b>Earthing clip</b> 1007505
	<b>Esdec Mounting Screw Cap, black*</b> 1006500		<b>Earthing bracket</b> 1007503
	<b>TPO mat</b> 1007015		

\* Combined with black systems  
\*\* Also available ready-assembled, see SYSTEM COMPONENTS

## Calculation

Calculation tool available:  
• Calculate ballast  
• Necessary materials  
• Work drawing



## Warranty

• Use of premium high-tech materials  
• Wind-tunnel tested  
• 20-year warranty

